

SCHEDULE OF DOORS			
NO.	SILL	LINTEL	SIZE
D1	2150	1100X2150	
D2	2150	900X2150	
D3	2150	750X2150	
D4	2150	1500X2150	
D5	2150	1100X2150	
FOD	2150	1100X2150	
SD	2150	2400X2150	

SCHEDULE OF WINDOWS			
NO.	SILL	LINTEL	SIZE
W1	950	2150	1500X2100
W2	950	2150	1200X2100
W3	950	2150	900X2100
W4	1550	2150	800X2100
W5	950	2150	1200X1400

SHEET NO.
M/S KAJLA BUILDERS
REPRESENTED BY: SHRI B. AGARWAL & CO. LATE BIRNATH AGARWAL
AT SHOP COMPLEX, 5/F, ROAD, SILIGURI - 731 001, WEST BENGAL, INDIA

SCHEDULE OF LAND
MUDA: SARADHARA
J.L. NO: 62
P.S. KHATAN NO: 9/91/1712
L.R. KHATAN NO: 98, 975, 971, 1435, 1772, 1376, 919
1433, 1437, 1396, 1374, 1377, 14795, 14796
287, 288, 289, 290, 313, 314, 315, 317, 334, 339, 340
R.S. PLOT NO:
L.R. PLOT NO:
L.R. SHEET NO: 1
PARGANA: PATHARGHATA
POLICE STATION: MATIGHARA
DISTRICT: DARJEELING

SITE LOCATION: NEAR GYANJYOTI MORE, DAGAPUR, SILIGURI

GENERAL NOTES:

1. ALL DIMENSIONS ARE IN MILLIMETRES.
 2. ONLY WRITTEN DIMENSIONS ARE TO BE FOLLOWED.
 3. ALL EXTERNAL WALLS ARE 200MM THICK AND INTERNAL WALLS ARE 100MM THICK UNLESS OTHERWISE NOTED.
 4. ALL SHOPS ARE ARTIFICIALLY LIGHTED & MECHANICALLY VENTILATED.
 5. GRADE OF STEEL IS Fe-500 AND GRADE OF CONCRETE IS M-30.
 6. TOLERABLE TO BE USED FOR FLOORING.
- DECLARATION OF OWNER**
I DECLARE THAT I SHALL NOT ALTER OR MAKE ANY ADDITION OR ALTERATION TO THIS PLAN, DESIGN AND SUPERSTRUCTURE OF THE BUILDING WITHOUT THE WRITTEN PERMISSION OF THE ARCHITECT. I SHALL BE RESPONSIBLE FOR THE CONSTRUCTION OF THE BUILDING UNDER MY SUPERVISION AND I SHALL BE RESPONSIBLE FOR THE MAINTENANCE OF THE BUILDING.

For KAJLA BUILDERS
Partner

SIGNATURE OF ARCHITECT

DECLARATION OF ARCHITECT
I CERTIFY THAT THE PLAN HAS BEEN DESIGNED AND DRAWN UP STRICTLY ACCORDING TO THE S.C.M. AND S.C.A. RULES AND ALSO CERTIFIED THAT THE FOUNDATION AND SUPERSTRUCTURE OF THE BUILDING HAVE BEEN DESIGNED TO SAFE W.L.L. RESPECTS INCLUDING THE CONSIDERATION OF SEISMIC CAPACITY AND SETTLEMENT OF SOIL.

SIGNATURE OF STRUCTURAL ENGINEER

MITUL SHUKLA (B.A.R.C.I.)
CA79603221
SIGNATURE OF ARCHITECT / L.B.S.

DECLARATION OF STRUCTURAL ENGINEER

THE STRUCTURAL DESIGN AND DIMENSIONS OF BOTH FOUNDATION AND SUPERSTRUCTURE OF THE BUILDING HAS BEEN MADE BY ME CONSIDERING ALL POSSIBLE LOADS INCLUDING THE SEISMIC LOADS AS PER THE NATIONAL BUILDING CODE OF INDIA AND OTHER RELEVANT CODES, AND CERTIFIED THAT IT IS SAFE AND STABLE IN ALL RESPECTS.

SIGNATURE OF ARCHITECT

Dr. Smita Tung
Civil Engineer, Class - I
SMD Registration Number: 917
27, Laxmi Saran, Durgam Chatterjee, Siliguri
Ph: 9019582250
Email: smitatumg1@gmail.com

SIGNATURE OF ARCHITECT

PROJECT:
PROPOSED G+V STORED RESIDENTIAL CUM MERCANTILE RETAIL BUILDING AT MOUZA - SARADHARA, J.L. NO. - 62, KHATAN NO. - R.S. 9/91, 7752, L.R. NO. 975, 971, 1435, 1772, 1376, 919, 1433, 1434, 1369, 1374, 1377, R.S. PLOT NO. - 136, 147, 149, 166, 168, 363, 364, 147365, 147366, L.R. PLOT NO. - 287, 288, 289, 290, 295, 313, 314, 315, 317, 334, 329, 330, L.R. SHEET NO. - 01, PARGANA: PATHARGHATA, P.S.: MATIGHARA, DIST.: DARJEELING

TITLE:

GROUND FLOOR PLAN FIRST FLOOR PLAN TYPICAL FLOOR PLAN (TOWER-01)

SCALE:

DRAWN BY: MONISHA
CHECKED BY: RATAN
DATE: 28.03.2022
SCALE: 1:200 & 1:100

ARCHITECT:

Mass & void Architect & Interior Consulting

56 Christopher Road,
4th Floor, 4b The Ekta Hibiscus,
Kolkata-700 046, P 033 2328 2264
E Mava2003@gmail.com, W Www.massandvoid.com



TYPICAL (2ND TO 5TH) FLOOR PLAN (TOWER-01) SCALE - 1:100

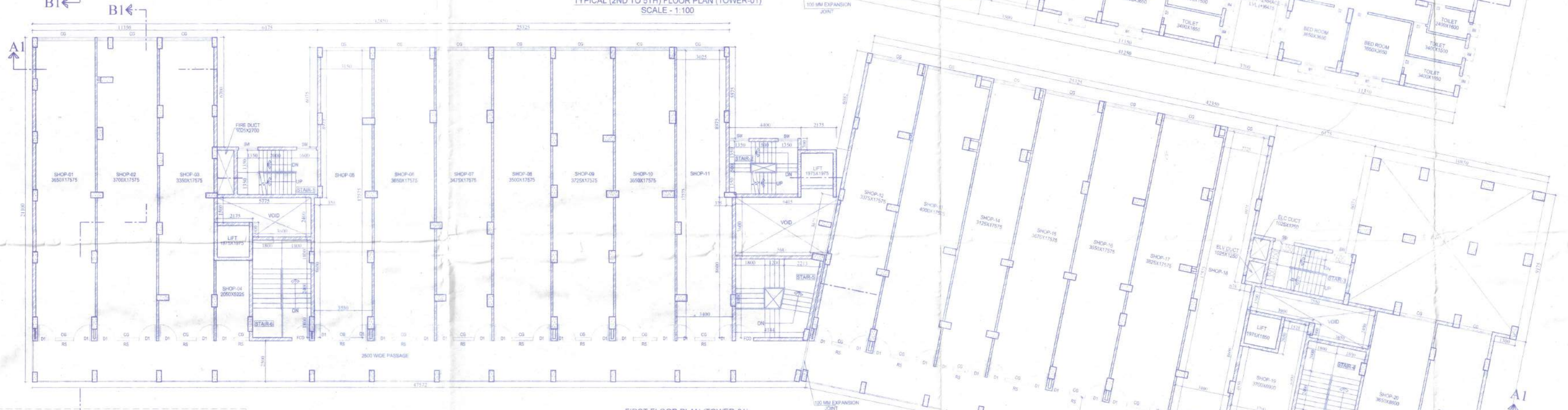

FIRST FLOOR PLAN (TOWER-01) SCALE - 1:100

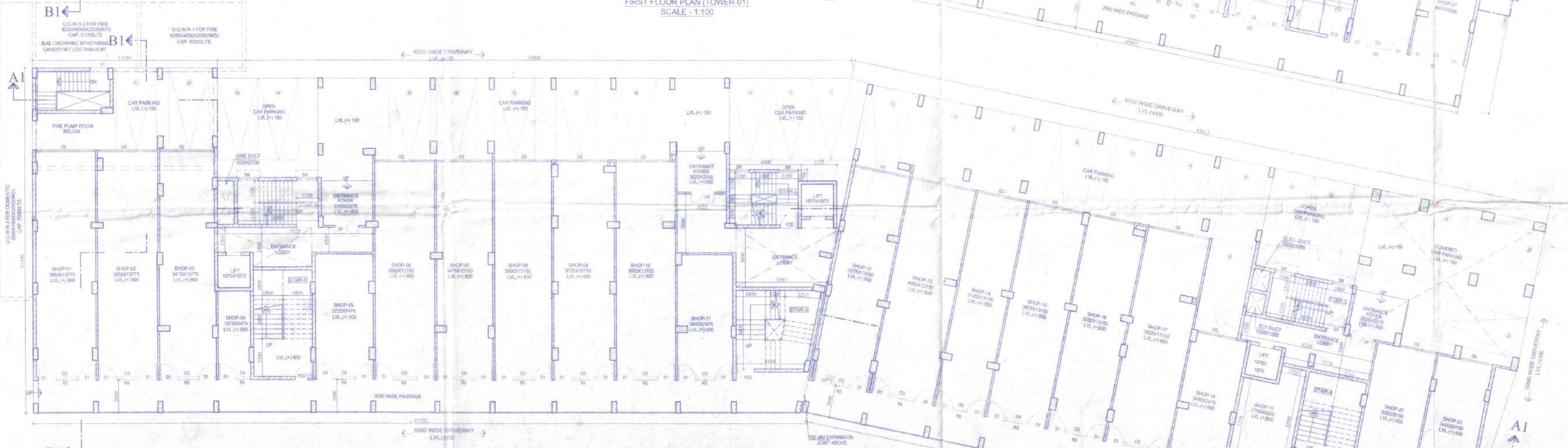

GROUND FLOOR PLAN (TOWER-01) SCALE - 1:100

Blank space for stamp or signature.

Blank space for stamp or signature.

Blank space for stamp or signature.

Blank space for stamp or signature.

Sub Assistant Engineer (B.P.)
Matigara Development Block
P.O. Katambala, Dist. Daryelg
Executive Officer
Matigara Panchayat Samiti
APPROVE

DATE 31/08/2013
ORDER NO. 372
M.P.S.
The construction of the building shall be supervised by the licensed Surveyor/Architect during the plan application. Unless otherwise approved by the Authority the permission shall remain valid for a period of TWO YEARS.
Registration No. / G.S. Permission Granted/Permission granted to be approved by the Matigara Panchayat Samiti, before the proposed construction undertaken.

PERMISSION GRANTED FOR TWO YEARS
Permission Granted/Per
Registration No. / G.S. Permission Granted/Permission granted to be approved by the Matigara Panchayat Samiti, before the proposed construction undertaken.

Technically Approved
District Engineer
Sigunt, Dist. Daryelg
Sigunt Mahakuma Parishad
May be Sanctioned
Architect
Sigunt Mahakuma Parishad